



**TAIPEI
EUROPEAN
SCHOOL**



Brief about School





THE SCHOOL

TES's vision is to be a flourishing, multilingual and multicultural community of lifelong learners that embraces independence, curiosity and empathy to make a positive difference in local, national and global environments. We aim to be the school of choice for parents, students and staff who are looking for excellent accredited education programmes delivered in a variety of languages and who want to join an active and caring community.

The mission of Taipei European School (TES) is to provide educational excellence, with European culture and values, within the context of Taiwan and local culture.

Located in the Republic of China (Taiwan), TES is fortunate to be offering our students quality international education while being immersed in the authentic and dynamic Chinese language and culture setting.

The School has attracted regional and worldwide attention with its unique model for integrating British, French, German and British High School sections in terms of their curricula, administration, finance, buildings and facilities. Taipei British School, Ecole Francaise de Taipei and Deutsche Schule Taipei began around 1990 in response to the needs of expatriate families living in Taipei. The schools soon realized that there was much to be gained by joining forces

to establish a combined European campus, and moved onto a shared campus in 1992. TES is now a single legal entity operating through a non-profit Foundation and comprising the original British, French and German school sections plus a High School established in 2002.

TES has grown steadily since its establishment and now has 1800 students of some 50 nationalities. TES operates on two campuses with well-appointed, modern facilities and has a total staff of around 400.

Teaching staff from TES come predominantly from the UK, France and Germany with smaller numbers from other European countries, Australia, New Zealand, Canada and USA. Taiwanese staff are employed in a variety of positions across school. Class sizes are maximum of 24 in British Sections with smaller classes across the British High School and in the French and German Sections.

In 2011 TES received full accreditation from two of the world's leading accreditation bodies. The Council of International Schools (CIS) and the Western Association of Schools and Colleges (WASC).

TES is well supported by the various foreign institutes as well as the international chambers of commerce and foreign businesses in Taipei.

SCHOOL GOVERNANCE

As a school combining three different curricula plus a High School, TES has in place a professional, integrated organizational structure providing efficient leadership and management. The executive body of the TES is governed by the Board of Directors (Foundation), which consists of 9 members. These 9 voting members are volunteers who are responsible for setting the strategic direction of the school.

The CEO is hired, supported and evaluated by the board. While the board sets the overall strategic direction and mission of the school, it delegates the accomplishments of that direction and mission to the CEO.

The CEO is the Executive Principal of the school but delegates significant responsibility to the respective Heads. The Head of each Section reports to the CEO. The CEO is also supported by the leadership team, covering the sections and the different administrative functions of the School.

THE CORE VALUES

Through world class curricula, Taipei European School cultivates lifelong learners and responsible global citizens who are ready to rise to the challenges of the future. We nurture independence, embrace diversity, and encourage all to “do well by doing good”. We embrace holistic education programmes that value academic accomplishment while prioritising the social and emotional well-being of each learner.

The school expects that we as a community

- Strive for excellence in all that we do
- Encourage the development of the whole person
- Sustain a strong ethos that emphasizes students’ welfare and their personal, social and emotional development
- Encourage students to pursue their natural curiosity thereby developing enquiring and challenging minds and enhancing their critical thinking and preparation for life- long learning
- Promote good citizenship through a concern and compassion for social, global and environmental issues
- Respect and celebrate the multicultural environment of our school which enriches our community and our learning
- Develop the potential of each member of our school community
- Maintain a strong partnership between our school, parents and the community



THE CURRICULUM

The British, French and German sections follow their respective national curricula up to the age of around 14 years. The British section broadly follows the English National Curriculum from Early Years through to Key Stage 3. The curriculum of the French section is based on the Programme du Ministère de L'Education Nationale Français, and students may enter for the Brevet des Collèges in class 3eme. The German section follows the curriculum of the state of Thuringen.

Considerable work has been undertaken in recent years to streamline the Vertical and Horizontal alignment of the curriculum across Primary and Secondary as well as across the sections. Currently, there are progressively arranged joint classes in subjects such as Chinese Language and Culture, physical education, music and art, as well as coordinated breaks, lunch times and extra-curricular activities. The result is that the students are leading the way in demonstrating how friendships and co-operation can flourish across different nationalities and language groups.

From 14 to 18 years of age, the students enter the High School Section, which offers two distinct two-year programmes, taught mainly in English, but with some French and German curricular units. Students from the age of 14 to 16 follow a number of IGCSE core and optional subjects, culminating in examinations at the end of the second year. The 16 to 18-year-olds undertake the International Baccalaureate (IB) Diploma Programme or the French Baccalauréat, largely as a preparation for university or college entrance. There is also the possibility for our French section students to take the French national exams (the Brevet).





Upcoming Changes

The school is currently undergoing a construction project to relocate our Middle School to a brand-new building expected to be completed in 2024, as well as an ongoing renovation project to bring new built-for-purpose facilities to our upper secondary campus. The relocation of the Middle School and the redevelopment of the Upper Secondary Campus will bring opportunities for a visionary leader to join the transformation of the school. The Middle School will transition to the IB Middle Years Programme (MYP) over a period of five years to gradually replace the UK Key Stage 3 and IGCSE. The existing IBDP programs will be enriched with opportunities made available with the additional learning space for purpose-built facilities development.



THE CAMPUSES

TES operates on two campuses - Swire European Primary Campus in Shilin offers convenient first-class learning spaces for the younger students. The Secondary campus is located in YangMing Shan national park and offers spectacular views of the city as well as first-class learning spaces. The Primary Campus and Secondary Campus are designed with the age group's most appropriate learning environment in mind.



Primary Campus

Housing Nursery through to upper Primary, the school is split into zones with classrooms and other learning spaces for the needs of each age group. Separate playgrounds for Nursery, Infant, and Primary ensure the children are happy and engaged. Classroom learning spaces are large and we can create spaces where the children feel comfortable to learn. Teachers are able to adjust the space to fit different learning goals. A sports field offer the space and facilities to support PE classes and Sport opportunities after school as well as play space at break times.



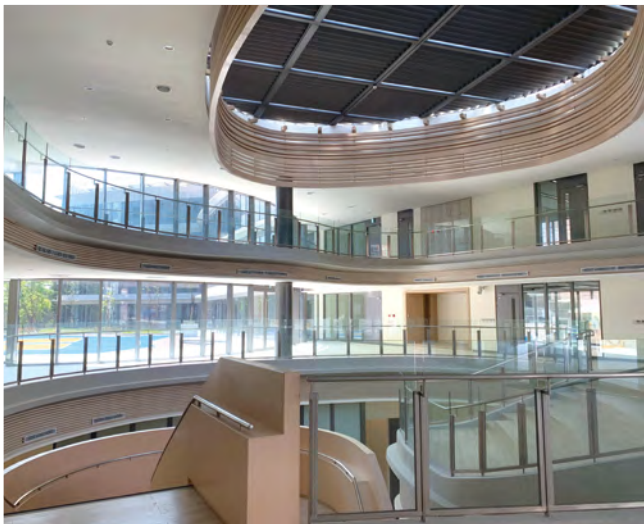

Secondary Campus

The campus has 3 buildings which offer fit-for-purpose learning areas. With the new building completed in 2020 offering 2 underground gymnasiums, a weights room, a dance studio, as well as highly advanced classroom spaces where technology is utilised for best practice teaching. There is also a Sports Centre located close by, ensuring football pitch space, tennis courts are available for PE lessons.



CULTURE AND COMMUNITY

As the only school in Taiwan offering a British, French and German national curriculum option - we are the natural choice for a more diverse background of parents and students. Our international community is truly diverse with over 50 nationalities represented. While our school culture reflects the influences of our European heritages, British, French and German, we recognise all cultures. We have strong connections to the context of our host country, Taiwan, and take every opportunity to draw upon the host country in our educational programmes.



LIFE IN THE REPUBLIC OF CHINA (TAIWAN)

The Republic of China (hereafter ROC or Taiwan) is a semi-tropical island in East Asia, one of the world's most exciting and rapidly changing regions. The main island, known historically as Formosa, makes up 99 per cent of the area controlled by the ROC, along with a number of small islands in the Taiwan Strait including the Penghu archipelago, the Kinmen and Matsu Islands.

Taiwan's friendliness, clean air, safety, health care system, and the overall quality of life have helped put it above the likes of the USA, Australia, and Hong Kong as one of the best places in the world for expats to live. The people of Taiwan are extremely friendly, helpful, and interested in foreigners. The expatriate population is smaller than in some other Asian cities, but the community is close-knit and welcoming to newcomers.

Taipei is the political, economic, educational and cultural center of Taiwan. Taipei is a developed, vibrant city of around three million people. Described by the International Herald Tribune as the "world's most underrated capital city", it is not especially large by Asian standards and rather less congested and less polluted than most other Asian cities. The city offers many opportunities for recreation, both sporting and cultural. It boasts many theatres, nightclubs, concert halls, museums, and temples, and it is therefore easy for people to enjoy an active social life. Taipei's eateries, ranging from street stalls to Michelin-starred restaurants are a real culinary treat for foodies. The mountains surrounding the city offer a quick and scenic get-away, and the rest of Taiwan and its surrounding islands are well worth exploring. As a country, Taiwan is also well situated for excursions to other attractive locations in South East Asia, such as Japan, Thailand, Vietnam, the Philippines and Malaysia.

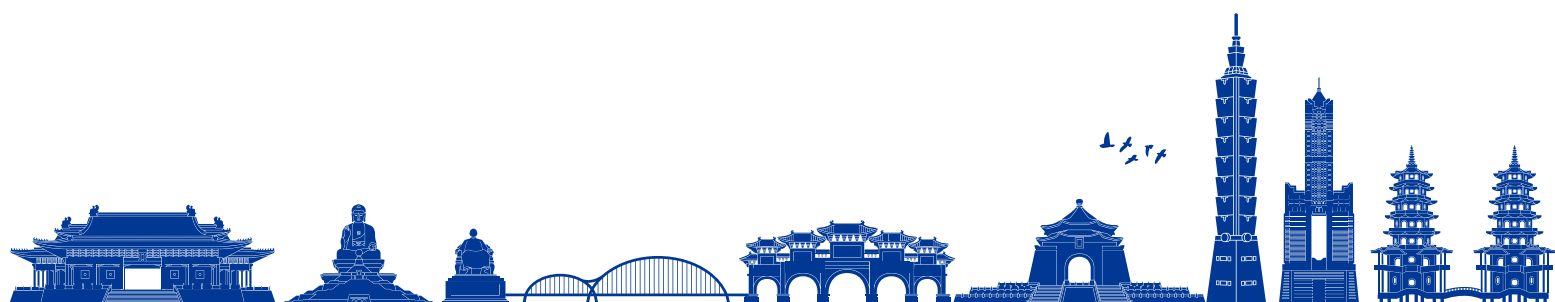

Swire European Primary Campus

 99 FuGuo Road, ShiLin District
Taipei 11158, Taiwan ROC

 Tel: +886-2-8145-9007

Swire European Secondary Campus

 31 JianYe Road, ShiLin District
Taipei 11193, Taiwan ROC

 Tel: +886-2-8145-9007

 <https://www.tes.tp.edu.tw/>